

State of Wyoming Corner Record

(In compliance with the *CORNER PERPETUATION AND FILING ACT*, Wyoming Statutes, 1997 Section 33-29-140 et. seq., and the Rules and Regulations of the Board of Professional Engineers and Professional Land Surveyors)

Reverse side of this form may be used if more space is needed.

Record of original survey and citation of source of historical information (if corner is lost or obliterated). Description of corner monumentation evidence found and/or monument and accessories established to perpetuate the location of this corner. Sketch of relative location of monument, accessories, and reference points with course and distance to adjacent corner(s) (if determined in this survey). Method and rationale for reestablishment of lost or obliterated corner.

LOCATION: East Quarter Corner of Section 27, T14N, R65W, 6th Principal Meridian, Laramie County.

RECORD: GLO - Set granite boulder 16" x 8" x 5"

2007 - Carl Carmichael found the original stone, which was measured and recorded. He returned to replace the deteriorated stone with a current monument and the stone was found to be removed by an unknown party. He set a 3.25" aluminum cap stamped LS 10838 based on the location of the original stone. He notes a distance of 2640.94' to NE 27-T14N-R65W and 2635.00' to SE 27-T14N-R65W.

RECOVERED: 2019 - Westwood Professional Services found a 3.25" aluminum cap stamped LS 10838 as described in 2007 survey and 1 tie.

RESET: Accepting location of the monument as the corner location. Set additional ties as shown.

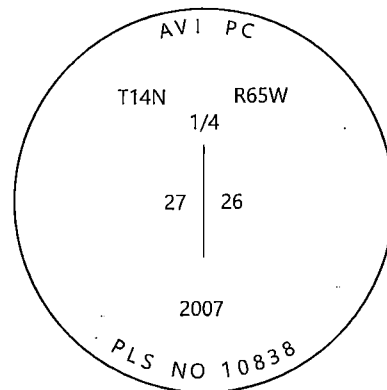

Monument Inscription

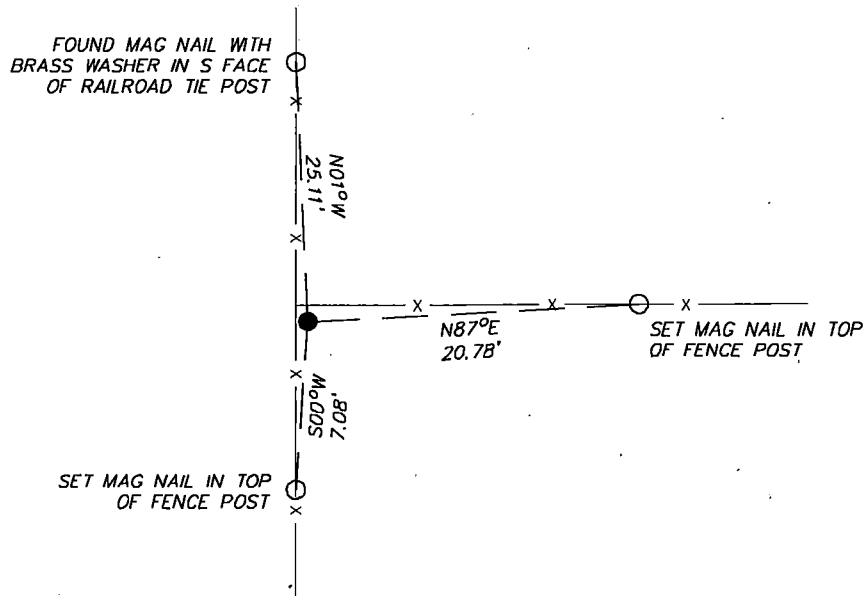

Date of Field Work: 10/12/2019

Office Reference: 22237.02

Cross Index Plat

	1	2	3	4	5	6	7	8	9	10	11	12	13	14	15	16	17	18	19	20	21	22	23	24	25		
A																											A
B																											B
C		6																									C
D																											D
E																											E
F																											F
G																											G
H																											H
J																											J
K																											K
L																											L
M																											M
N																											N
O																											O
P																											P
Q																											Q
R																											R
S																											S
T																											T
U																											U
V																											V
W																											W
X																											X
Y																											Y
Z																											Z
	1	2	3	4	5	6	7	8	9	10	11	12	13	14	15	16	17	18	19	20	21	22	23	24	25		

Firm/Agency, Address

Westwood Professional Services
 3701 12th St. N. Ste. 206
 St. Cloud, MN 56303

This corner record was prepared by me or under my direction and supervision.

SEAL & SIGNATURE

Telephone Number: (320)-253-9495

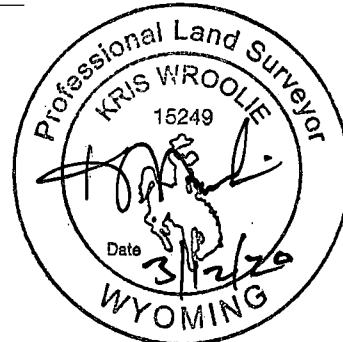

REC# 775847
 RECORDED 4/15/2020 AT 10:17 AM BK# 2668 PG# 279
 Debra K. Lee, CLERK OF LARAMIE COUNTY, WY PAGE 1 OF 1

Corner Name East Quarter Corner Section 27, T 14 N, R 65 W, 6th P.M. Cross-Index No.: T-17

County: Laramie Wyoming

SBRPEPLS/PLSW: March 1994; PLSW January 1998